



TRUCK AND BUS VALVES

Straight clamp-in valves used on both demountable and non-demountable rims. For .625" diameter valve hole. **Bent valve stems also available. Haltec custom bends the TV-570 series valves.**

HALTEC NO.	TR NUMBER	EFFECTIVE LENGTH
TV-500	500	2"
TV-501	501	1 1/2"
TV-570	570	3 1/8"
TV-571	571	3 3/8"
TV-572	572	3 3/4"
TV-573	573	4 3/8"
TV-574	574	5"
TV-575	575	1 1/8"

CUSTOM BENT VALVES AVAILABLE UPON REQUEST

Haltec can custom bend and fabricate any tire valve hardware at its manufacturing facility in Salem, Ohio. This allows us to provide prototype samples which ultimately lead to innovative solutions for our customers.

TV-572-HT WITH HIGH TEMP GROMMET

Equipped with the G-170S high temperature grommet. Ideal for buses, cement trucks, and garbage trucks.

TV-573-HT WITH HIGH TEMP GROMMET

Equipped with the G-170S high temperature grommet. Ideal for buses, cement trucks, and garbage trucks.

QS-500 2" REPLACEMENT QUIKSTEM VALVE

Fits 5/8" (.625) valve hole. Will replace broken valve stems on farm equipment, construction vehicles, commercial vehicles and more. Designed to install from outside of wheel to reduce vehicle down time and allow you to continue working until tire service is convenient. Can be installed with a 9/16" socket or wrench. Installs easily in 1 minute.

QS-430 1 3/16" REPLACEMENT QUIKSTEM VALVE

Same use as the QS-500. Fits a .453 valve hole. Can be installed with a 1/2" socket or wrench.

SNAP-IN TIRE VALVE & CHROME SLEEVE TIRE VALVES

HALTEC NO.	TR NO.	EFFECTIVE LENGTH	VALVE HOLE	NOTES
TV-412	412	7/8"	.453	Rubber Sleeve
TV-413	413	1 1/4"	.453	Rubber sleeve
TV-414	414	1 1/2"	.453	Rubber sleeve
TV-415	415	1 1/4"	.625	Rubber sleeve
TV-418	418	2"	.453	Rubber sleeve
TV-423	423	2 1/2"	.453	Rubber sleeve
TV-425	425	2"	.625	Rubber sleeve
TV-413-CH		1 1/4"	.453	Chrome sleeve
TV-418-CH		2"	.453	Chrome sleeve

Maximum cold inflation pressure 65 PSI.

51025 QUICK VALVE CHANGE TOOL

- Change a tire valve in 10 seconds
- Ideal for leaking valve stems
- For use only with .453 valve stems



51025

TECH TIP

ALL GROMMETS ON 570 SERIES VALVES ARE MADE IN THE USA

EINKY VALVES

A high-performance "No Show" type chrome-plated valve that installs from the outside. A rubber washer and nut are on the inside.

HALTEC NO.	BEND ANGLE	EFFECTIVE LENGTH	VALVE HOLE
TV-6010	STR.	3/4"	.453
TV-6020	45°	1 1/16"	.453
TV-6030	STR.	1 1/4"	.453
TV-6040	STR.	1 3/4"	.453
TV-6050	90°	1 3/16"	.453

CLAMP-IN VALVE

Used on car and light truck applications. Maximum inflation pressure 130 PSI.

HALTEC NO.	TR NO.	EFFECTIVE LENGTH	VALVE HOLE	NOTES
TV-416	416	1 1/4"	.453 or .625	-
TV-416L	-	2"	Both grommets furnished	
TV-416LF-18	-	2"	.453	For use on utility trucks, equipped w/DS-1
TV-416FLG-18	-	2"	.625	For use on utility trucks, equipped w/DS-1

TV-575HP/DS-1

- Ford .453 "Cut-Away" and Cargo Van Series with Single Rear Wheels
- Accuride Steel 16" x 7" Wheels
- Front & Rear Wheels
- Chrome Finish
- .453

N-1600

- Ford "F" Series Trucks with Dual Wheels
- Alcoa Aluminum 16"
- Front & Rear Wheels
- Chrome Finish
- .453

TV-416LF

- Ford "Cut-Away" Series with Dual Wheels
- Accuride Steel 16" x 16" Wheels
- Front & Rear Wheels
- Nickle Finish
- .453

TV-416/DS-1

- Ford "F" Series Trucks with Dual Wheels
- Accuride Steel 19.5"
- Front & Rear Wheels
- Nickle Finish
- .453

TV-416MC

- Ford "F" Series Trucks with Dual Wheels
- Accuride Steel 16" x 16"
- Front & Rear Wheels
- Nickle Finish
- .453

TECH TIP

ALL HALTEC SNAP-IN VALVES PASS ALL SAE REQUIREMENTS





TV-430 CH-505

NEW

TV-430 TUBELESS MOTORCYCLE VALVE
Has O-ring seal, fits .327" valve holes. Effective length is 1 3/16".

CH-505 MOTORCYCLE CHUCK
Angled design to fit between the brake rotor and the hard to reach valve. Easy on/off locking coupler. Hardened steel pins for increased service life. 1/4" NPT female threads. 8" long. Order CH-505OP for open chuck.



TV-575-HP TV-6008C

TV-575-HP
Low profile with 1" E.L. Has grommets to fit either .453" or .625" diameter valve hole.

TV-6008C
Tractor Front Wheel Valve Low profile valve offers minimum protrusion above the rim. 9/16" effective length with chrome finish. Fits .453" or .625" valve hole.



TV-6008 H-523MS

TV-6008
Same as above except brass finish.

H-523MS ALUMINUM VALVE
A light aluminum valve used on racing and light alloy wheels. Fits .453" valve hole and has O-ring seal.



TV-801-HP TV-802-HP TV-600-HP TV-602-HP

HIGH-PRESSURE TUBELESS TIRE VALVE
TV-600-HP and TV-602-HP used to 80 PSI cold inflation pressure, and fits .453" diameter valve hole, maximum rim thickness .205" at valve hole. TV-801-HP and TV-802-HP used to 100 PSI cold inflation pressure, and fits .625" diameter valve hole, maximum thickness .205" at valve hole. Designed for use with transporting mobile homes.

HALTEC NO.	TR NO.	EFFECTIVE LENGTH	VALVE HOLE
TV-600-HP	600HP	1 1/4"	.453"
TV-602-HP	602HP	2"	.453"
TV-801-HP	801HP	1 1/4"	.625"
TV-802-HP	802HP	2"	.625"



N-1147 N-1147L

N-1147 RADIAL COMMANDER
Valve N-1147 for 15" Disc Wheels 23° bend clamp-down valve for .625" valve hole. Bend allows clearance of brake drum for tire service.

CUSTOM BENT VALVES AVAILABLE UPON REQUEST
Haltec can custom bend and fabricate any tire valve hardware need at its manufacturing facility in Salem, Ohio. This allows us to provide prototype samples which ultimately lead to innovative solutions for our customers.

SCREW-ON REPAIR VALVES

HALTEC NO.	TR NO.	EFFECTIVE LENGTH
RV-1177A	1177A	3 1/4"
RV-1077A	1077A	4 1/8"
RV-1175A	1175A	4 1/2"
RV-1078A	1078A	5"
RV-1179A	1179A	5 5/8"

For trucks and bus, tube-type tires. A quick replacement for broken tube valves with body thread. Cut off valve and screw on repair valve without cutting out old valve base (with bridge washer). Can be used with SP-1000 tube spud.



RV-1078A

METRIC RIM HOLE VALVE (9.7MM VALVE HOLE)

Some imported trucks will have steel wheels that incorporate the 9.7mm valve hole (.390"). These are the most popular valves for this application.

HALTEC NO.	ETRTO	BEND	A HEIGHT	B HEIGHT	FINISH	SEAL
41 MS-00	V3-20-1	Straight	1 5/8"	-	Brass	O-Ring
54 MS-00	-	Straight	2 1/8"	-	Nickel	Grommet
60 MS-00	-	Straight	2 3/8"	-	Nickel	Grommet
60 MS-27	-	27°	1 3/16"	1 5/32"	Nickel	O-Ring
70 MS-7	-	7°	1 19/32"	1 1/8"	Nickel	Grommet
70 MS-27	V3-20-5	27°	1 3/16"	1 9/16"	Nickel	O-Ring
70 MS-7SL	-	7°	1 19/32"	1 1/8"	Nickel	Grommet
80 MS-27	V3-20-7	27°	1 3/16"	2"	Brass	O-Ring
90 MS-27	V3-20-4	27°	1 3/16"	2 3/8"	Brass	O-Ring
115 MS-27	V3-20-6	27°	1 3/16"	3 3/8"	Brass	O-Ring
8135L	V3-22-1	45°	1 3/16"	1 1/16"	Brass	O-Ring
PVR-119	-	17.5°	1 11/32"	1 1/2"	Nickel	O-Ring

Other sizes available upon request

TRUCK VALVES FOR ALUMINUM TRUCK WHEELS

Tubeless valves used in drop-center aluminum disc wheels with .625 valve hole. Rubber grommet available (part #G-172).

HALTEC NO.	TR NO.	BEND ANGLE	E.L.
TV-509	TR-509	90°	4 3/4"
TV-510	TR-510	90°	5 1/2"
TV-511	TR-511	90°	4 1/4"

PRESET VALVE WRENCHES

Open-end choices for 5/8" or 9/16" Valve nuts. A durable and robust open-end due to chrome-vanadium alloy steel. The operator receives feedback indicating desired torque value is reached through the robust internal spring release.

Torque Settings

The 9/16" open-end is set to 42 in. lbs. and suitable for 570 Series Valves.

The 5/8" open-end is set to 100 in. lbs. and suitable for 540 and 550 Series Valves.

Note: Always consult with manufacturer instructions to confirm desired torque.

FOR 570 SERIES VALVES			FOR 540 & 550 SERIES VALVES		
PART NO.	OPEN-END	TORQUE SETTING	PART NO.	OPEN-END	TORQUE SETTING
PW18916	9/16"	42 in-lb	PW18058	5/8"	100 in-lb

TV-540 SERIES, O-RING SEAL VALVES FOR ALUMINUM TRUCK WHEELS (9.7 MM VALVE HOLE)

HALTEC NO.	VALVE TR NO.	A HEIGHT	BEND ANGLE	B LENGTH	HEX NUT
TV-542	542	1.25	-	-	HN-22
TV-543	543	2.4	-	-	HN-22
H-543C	543C	0.93	45°	1.43	HN-22
TV-543D	543D	0.98	60°	1.38	HN-22
TV-543E	543E	0.98	75°	1.38	HN-22
TV-544	544	2.9	-	-	HN-22
TV-544C	544C	0.98	45°	1.94	HN-22
TV-544D	544D	0.98	60°	1.94	HN-22
TV-545	545	3.5	-	-	HN-22
TV-545D	545D	0.98	60°	2.6	HN-22
TV-545E	545E	0.98	75°	2.6	HN-22
TV-546	546	4.25	-	-	HN-22
TV-546D	546D	0.98	60°	3.35	HN-22
TV-546E	546E	0.98	75°	3.35	HN-22
TV-546G	546G	0.98	105°	3.35	HN-22
TV-546-36	546-36	0.98	36°	3.35	HN-22
TV-547D	547D	0.98	60°	3.78	HN-22

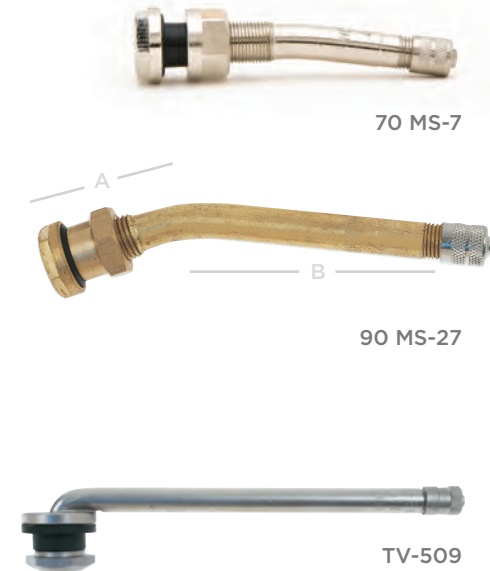

70 MS-7

90 MS-27

TV-509

TECH TIP

KEEP ALL O-RING SURFACES AS CLEAN AS POSSIBLE WHILE ASSEMBLING VALVES

NEW



PW18916 PW18058

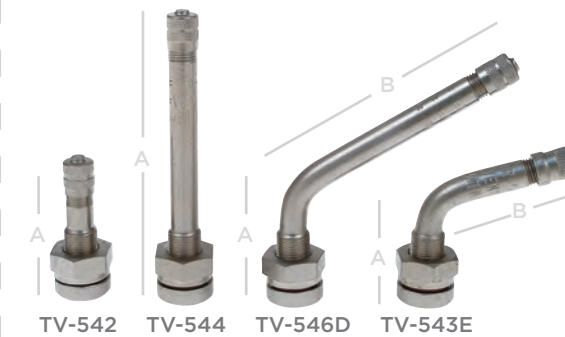

TV-542

TV-544

TV-546D

TV-543E

TECH TIP

THE SLOT ON THE BOTTOM OF THE 550 SERIES ALLOWS FOR EASY INSTALLATION



TV-550 SERIES

Features:

- Longer sealing life
- Greater corrosion resistance
- Larger sealing surface
- Slot and external hex for easier installation
- EPDM replacement grommet — G-551
- Grommet has better tear resistance
- Grommet must be used on TV-550 Series only, not for use on 540 valve series

GROMMET SEAL VALVES FOR ALUMINUM TRUCK WHEELS (9.7MM VALVE HOLE)

HALTEC NO.	VALVE TR NO.	A HEIGHT	BEND ANGLE	B LENGTH	HEX NUT
TV-552	552	1.26	-	-	HN-22
TV-553	553	2.4	-	-	HN-22
TV-553C	553C	.93	45°	1.43	HN-22
TV-553D	553D	.98	60°	1.38	HN-22
TV-553E	553E	.98	75°	1.38	HN-22
TV-554C	554C	.98	45°	1.94	HN-22
TV-554D	554D	.98	60°	1.94	HN-22
TV-555D	555D	.98	60°	2.6	HN-22
TV-555E	555E	.98	75°	2.6	HN-22
TV-556E	556E	.98	75°	3.35	HN-22

AIR-FLEXX VALVE EXTENSIONS



Conventional extensions hold the full air pressure in the extension chamber. Damage to the extension through wear or accident may mean the loss of a tire.

Air-Flexx valve extensions are flexible but rigid enough to be used without a rim holder, clamp or stabilizer.

Air-Flexx valve extensions are flexible but rigid enough to be used without a rim holder, clamp or stabilizer saving time and money. The extension withstands severe cold and heat without becoming brittle. The plastic casing will not corrode. The pin in the extension opens the tire valve only when checking pressure or inflating. If the extension is cut in half or broken no pressure is lost from the tire.

HALTEC NO	APPLICATION	LENGTH
HE-340	Steer & Single Wheels with Hubcaps*	2 15/16" (75mm)
HE-341	Steer & Single Wheels with Hubcaps*	3 5/16" (85mm)
HE-342	Inner Dual Tires or Steer & Single Wheels with Hubcaps*	4 1/8" (105mm)
HE-343	Inner Dual Tires*	5 11/16" (145mm)
HE-344	Inner Dual Tires*	7 1/4" (185mm)
HE-345	Inner Dual Tires*	8 7/16" (215mm)
HE-346	Inner Dual Tires or Spare Wheels**	12 3/8" (315mm)
HE-347	Inner Dual Tires or Spare Wheels**	16 5/16" (412mm)
HE-348	Inner Dual Tires or Spare Wheels**	39 3/8" (1000mm)

* No need for clamp, holder or stabilizer
 ** For use on spare wheels with angled extension of 45°, 90°, 135° or 180°



Use with a DS-1 flow-through valve cap to save time



HE-341



HE-343



HE-345

TRUCK VALVE EXTENSIONS

HALTEC NO.	DESCRIPTION	COLLAR TYPE	EFFECTIVE LENGTH
HE-369	Truck Extension	Short 3/8"	1 3/8"
HE-370	Truck Extension	Short 3/8"	2"
HE-371	Truck Extension	Short 3/8"	2 15/16"
HE-372	Truck Extension	Short 3/8"	3 15/16"
HE-373	Truck Extension	Short 3/8"	5 1/8"
HE-389	Truck Extension	Long 1"	1 1/16"
HE-390	Truck Extension	Long 1"	2"
HE-390A	Truck Extension	Long collar	2"
HE-391	Truck Extension	Long 1"	2 15/16"
HE-391A	Truck Extension	Long collar	2 15/16"
HE-392	Truck Extension	Long 1"	5 1/8"
HE-392A	Truck Extension	Long collar	5 1/8"
HE-393	Truck Extension	Long 1"	6"
HE-393A	Truck Extension	Long collar	6"
HE-394	Truck Extension	Long 1"	8.0"
HE-395	Truck Extension	Long 1"	10.0"
HE-396	Truck Extension	Long 1"	12.0"
HE-397	Truck Extension	Long 1"	14.0"
HE-4430	Truck Extension	Long 1"	4"
Standard Style	-	-	-
HE-381	Truck Extension	Long 1"	3 1/16"
HE-382	Truck Extension	Long 1"	5 1/16"
HE-383	Truck Extension	Long 1"	6 1/16"

*DS-1 cap compatible with all extensions

HE-370 SERIES LIGHTWEIGHT EXTENSIONS

Series has the short collar for use on tube-type or tubeless valves. Available in 2"-3"-4" and 5" effective lengths. Has a double seal feature to assure a positive seal. .305-32 cap thread.



HE-380 SERIES STRAIGHT METAL EXTENSIONS

These screw on the standard valve stem (.305-32 cap thread) and make the valve mouth accessible for service. .305-32 cap thread.



HE-390 SERIES LIGHTWEIGHT EXTENSIONS

Lightweight extensions are the same as above except with a long collar.



HE-390A SERIES LIGHTWEIGHT ALUMINUM EXTENSIONS

Extremely light weight aluminum extensions.



ALCOA STABILIZER & EXTENSION KIT

Proper air pressure is the most important factor in lengthening tire life. On dual wheel assemblies, the inner dual is many times overlooked or improperly serviced. The Alcoa Extension and Stabilizer Kit allows access to the inner dual tire valve and properly positions and supports the extension for servicing. The stabilizer reduces the road vibration on the extension and practically eliminates valve stem breakage caused by vibration.

ALCOA STABILIZER

HALTEC NO.	FITS ALCOA WHEEL SIZE	DIAMETER HAND HOLE	HOLE POSITION
FCSTBL	Freightliner, 19.5	Custom	Center
H-2125	19.5"	1.50"	Center
H-2126	19.5"	1.50"	Off-Center
H-2127	22.5 x 9.0	1.50"	Center
H-2225	22.5"	2.00"	Center
H-2245	24.5"	2.19"	Off-Center
H-2227	22.5"	2.50"	Center
H-2228	Peterbilt	Oval	Center
H-2247	24.5"	2.375"	Off-Center
H-27245	24.5	Hand Hole 2.69"	Off-Center
H-8864	22.5" & 24.5	2.50"	Off-Center
H-8964	Prevost	2.00"	Off-Center
H-2248	Freightliner	1.3125"	Center
MNCSTBL	Monaco Coach	Custom	Off-Center
ULTRASTB	Ultra	Custom	Off-Center



STABILIZER & EXTENSION KIT

HALTEC NO.	STABILIZER (2)	EXTENSIONS (2)
125392	H-2125	HE-392
126392	H-2126	HE-392
127392	H-2127	HE-392
127393	H-2127	HE-393
225392	H-2225	HE-392
225393	H-2225	HE-393
227392	H-2227	HE-392
227393	H-2227	HE-393
245392	H-2245	HE-392
247392	H-2247	HE-392
257392	H-2257	HE-392



TECH TIP

HALTEC'S DS-1 FLOW-THROUGH CAPS WILL INCREASE THE SPEED WITH WHICH YOUR FLEET DRIVERS AND MAINTENANCE TECHNICIANS COMPLETE THEIR TIRE MAINTENANCE. ALLOWS INFLATION AND DEFLATION AND PRESSURE CHECKS THROUGH CAP.



DS-1

DS-1G

DOUBLE SEAL CAP DS-1

The DS-1 flow-through valve cap is designed for high pressure truck tire service. Seals like a high pressure valve cap, yet offers the convenience of an inflate through extension. It also performs like a check valve-the seal becomes tighter in the event of a core failure. The DS-1 reduces pressure check time by 65% offering an efficient money and labor savings alternative to the common valve cap. The heat resistant grommets provide additional protection for the extended high temperature running. The DS-1 consists of a tough, all metal housing, precision fit brass components, and durable self-sealing O-ring.

Benefits:

- Inflate directly through sealing cap
- Reduces time and labor
- No lost valve caps

Technical Specifications:

- Overall length 7/8"
- Temperature rated seal: -40°F to 250°F

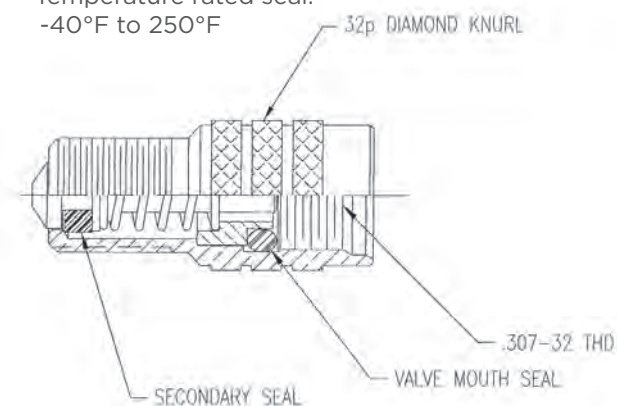

BENT EXTENSIONS FOR STANDARD BORE VALVES

HALTEC NO.	BEND	EFFECTIVE LENGTH	VERTICAL LENGTH
HE-200	90°	1 3/8"	3/4"
HE-201	45°	1 3/8"	3/4"
HE-202	135°	1 3/8"	15/16"
HE-203	24°	5 7/16"	N/A
HE-204	180°	1 7/16"	1/2"
HE-207	35°	4"	1 1/4"

DUAL WHEEL FLEXIBLE VALVE EXTENSIONS FE-300-LENGTH

This extension provides easy access to the inner dual tire found on campers, recreational vehicles, and light trucks. Fits standard valve cap threads. Comes with clamp to secure extension to wheel cut-out. 2 extensions per pack. Standard effective lengths are 7" and 9". Effective to 200 PSI Also available, clamp part number FE-300CL, which clamps directly to the lug nut. Other lengths available upon request.

SFE-400-LENGTH

Similar to the FE-300 series except has steel braid over rubber hose.

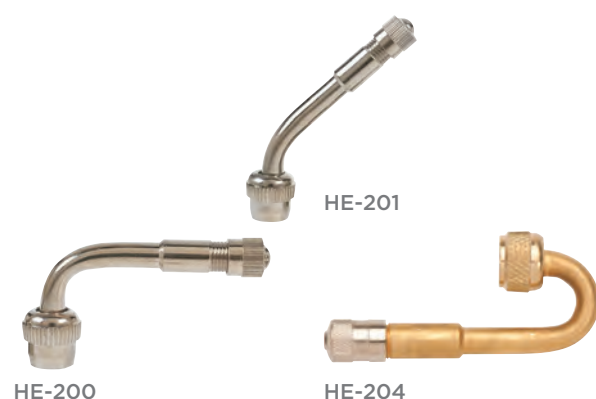

HE-200

HE-204

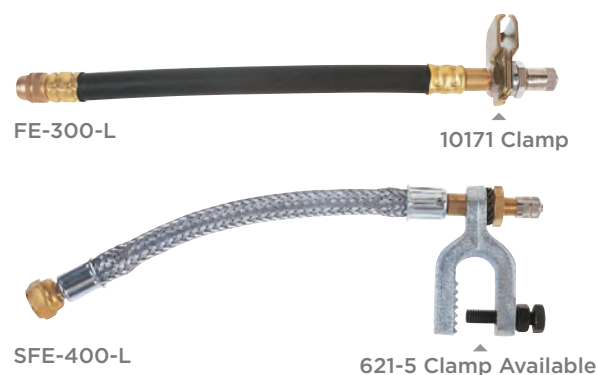

FE-300-L

10171 Clamp

SFE-400-L

621-5 Clamp Available

HIGH-PRESSURE SHOCK STRUT VALVES



Constructed of stainless steel bodies for use in high-pressure shock absorber units, hydraulic pressure accumulators, surge cylinders, and high-pressure pneumatic systems. Valves have 1/2" - 20 U.N.F. - 3A threads for connection to container.

H-7607 SHOCK STRUT VALVE

For operating pressure to 2,000 PSI. Conforms to AN-812-1.

H-4361 SHOCK STRUT VALVE

For operating pressure to 3,000 PSI. Conforms to AN-6287-1.

H-798 SHOCK STRUT VALVE

For use on shock struts where operating pressure is rated for 5,000 PSI. Conforms to MS-28889-2



H-7607

H-4361

H-798

H-6116B

Fits .305-32 thread size with 1/8" NPT female connection with 70° bend. Equipped with hard fiber sealing washer. Used up to 5000 PSI working pressure.

H-6116

Same as H-6116B except has straight extension.

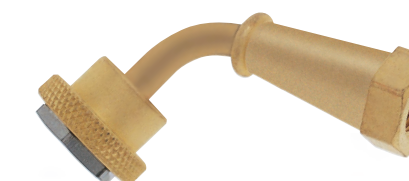

H-6116B



H-6116

5007

Fits .305-32 thread size with 7/16-20 thread for 1/4" flare tube fitting. Meets MS 33656E4. Maximum pressure rating is 15,000 PSI. Recommended torque 75 in-lb for steel valves. Has copper sealing washer.



5007

HIGH-PRESSURE INFLATING CONNECTIONS

H-556

Fits .305-32 thread size with 1/8" NPT male connection. Has core depressor pin, and copper sealing washer. Maximum working pressure 3000 PSI.

H-2755

Fits .305-32 thread size with 3/8-24 thread for 3/16" flare tube fitting, meets MS336556E3. Has core depressor pin and copper sealing washer. Maximum working pressure 3000 PSI.

2755L LARGE BORE HIGH-PRESSURE INFLATING CONNECTION

Fits .482-26 thread size with 3/8-24 thread for 3/16" flare fitting. Has core depressor pin and copper sealing washer. Maximum working pressure 3000 PSI.



H-556



H-2755



2755L



AIR LIQUID VALVES FOR TRACTOR AND ROAD GRADER SERVICE

HALTEC NO.	TR NO.	A	B	BEND ANGLE	VALVE HOLE
TV-618A	TR-618A	1 7/8"	-	-	0.625"
TV-618B	TR-618B	1 1/2"	-	-	0.625"
TV-618RB	-	1 1/2"	-	-	0.625"
TV-618A-SS	TR-618A-SS	1 7/8"	-	-	0.625"
TV-619A	TR-619A	1 7/8"	-	-	0.812"
TV-621A	TR-621A	1 1/2"	3	65°	0.625"
TV-622A	TR-622A	1 3/4"	4 1/2	90°	0.625"
TV-623A	TR-623A	1 1/2"	2 1/4	65°	0.625"
N-1000	-	1 7/8"	-	-	0.812"
H-50	TR-F910B	1 13/16"	-	-	0.812"

TV-5905 AIR/ LIQUID EXTENSION

Used with tractor or grader valve stems. 90 degree angle for more accessible valve.



TRACTOR AND GRADER TUBE

HALTEC NO.	TR NO.	BASE DIAMETER	CORE HOUSING	VERTICAL HEIGHT	VALVE HOLE
TV-218R	TR-218A	2 1/2"	TV-CH-3	1 7/8"	0.625"
TV-220R	TR-220A	2 1/2"	TV-CH-3	2 15/16"	0.625"
TV-916R	TR-916A	3 1/4"	R-372	1 7/8"	0.812"

Valve assemblies with removable core housing for liquid fill. Has Vulc-on back to allow field repair.

B9A BUSHING ASSEMBLY

Fits over TR-218A and TR-220A valves to allow use of valve in the 13/16" valve hole. Consists of B9-1 bushing and B9-2 nut.

LN-10 PLASTIC RIM NUT

Rim nut for tractor tube valves TR-218A and TR-220A. For brass rim nut, order **LN-10B**. See page 57 for TL-LN-10 installation tool (only fits LN-10).

B-6 BUSHING

Fits over TR-13 tube valve when used in 5/8" valve hole.

RIM HOLE PLUGS

P-15 FOR TUBE-TYPE WHEELS

Used to plug 5/8" rim hole and avoid tube "pouching."

T-30

Used to seal 13/16" rim hole when relocating valve.

N-1012S

Used to seal 5/8" rim hole when relocating valve.

ALSP

Air-liquid spud plug. Used to replace TV-CH-3 core housing.



CORE HOUSING

TV-CH-1

Fits old style TR-218 and TR-220 valves.



TV-CH-3

Fits all fast flow air-liquid valves except Super Large Bore.



R-372

Fits SP-816 tube spud and T-81 & C-100 spud.



310 VALVE ADAPTER GUN

Has a 1/2" female pipe thread and will attach to any calcium tire filling pump. It will extract the valve core from a Standard or Large Bore valve or the core housing from a tractor valve. It will securely hold the valve core or core housing up in the gun body during tire filling or evacuation of liquid from a tire. Due to the design, it will permit faster evacuation of liquid from a tire than with other adapter guns. Replaces Deming #1010.

Parts List:

- FP-134 Large Bore Core Remover
- FP-135 Adapter for Standard Valve (Equipped with FP-136)
- FP-136 O-Ring for FP-135 Adapter
- FP-137 Standard Valve Core Remover
- FP-138 Ejector Union (Equipped with FP-146)
- FP-139 Gasket
- FP-140 Stem
- FP-141F Adapter Body
- FP-142 Stem Sealing Nut
- FP-143 O-Ring for FP-142 (Stem Seal)
- FP-144 Hand Wheel
- FP-145 Lock Nut
- FP-146 Teflon Gasket

310-K Repair Kit Includes:

- FP-134
- FP-135
- FP-136
- FP-137
- FP-143
- FP-146

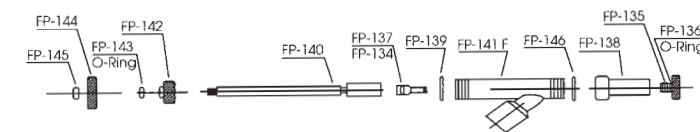

N-1057

Flexible extension for 310 gun.



AQF-1 AQUA QUICK FILL HALTEC

Patent No. 5.007.448 Haltec's Aqua Quick Fill is a simple, time-saving tool that allows the user to fill a tractor tire or large off-the-road tire with liquid and do other tasks while the tire is being filled. No longer does the user have to stand by and vent the excess air pressure. With the AQF-1, air is automatically vented through a side port while the liquid is being injected into the tire. When the tire is filled, the water escapes from the vent hole, indicating that the tire is full.

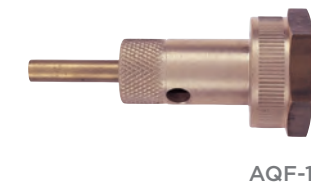

FLUID CONNECTORS

Coupler N-1451, 1/2 NPT female thread. Designed specifically for fluid use.



NIPPLE N-1452

1/2 NPT male thread. For fluid use.

N-1091 WATER ADAPTER

N-1091 For liquid fill tires.

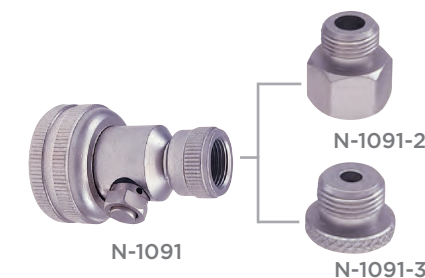

VALVE CORES

HALTEC NO.	TIRE & RIM NO.	DESCRIPTION
A-100-VC-1	C-1	Standard Bore Heat-Resistant Core for Cars, Trucks and Busses
A-100-VC-1-FC	C-1	Standard Bore Heat-Resistant Filter Core for Cars, Trucks and Busses
A-144	C-2	Large Bore Core (long). Fits 305-32 Threads
A-145	C-2	Large Bore Core (short). Fits 305-32 Threads

VALVE CAPS (STANDARD BORE)

HALTEC NO.	TIRE & RIM NO.	DESCRIPTION
57TT	-	Short dome cap.
89TPMS-CAPG	-	Chrome-Plated Plastic Hex Cap for TPMS
A-100-VC-2	VC-2	Metal Screwdriver Valve Cap for Removing Valve Cores
A-100-VC-3	VC-3	Metal Dome Valve Cap
A-100-VC-8	VC-8	Plastic Dome Valve Cap
A-100-VC-8G	VC-8	Plastic Green Dome Valve Cap
A-100-VC-12	-	Heavy-Duty Dome Cap for Truck Service. Has Heat-Resistant Sealing Washer.
DS-1	-	Double Seal Valve Cap
DS-1G	-	Double Seal Valve Cap (Green)
N-1202	-	Chrome-Plated Hex Cap

VALVE CAPS (LARGE BORE)

HALTEC NO.	TIRE & RIM NO.	DESCRIPTION
A-148	VC-6	Screwdriver Valve Cap. Fits .482-26 Valve Threads.
A-149	VC-7	Hex Valve Cap for Easy Tightening and Removing with Wrench. Fits .482-26 Valve Cap
A-147	A-10	Dome Cap
8807N-3	VC-4	Screwdriver Cap for 8807N-4 and AD-1 Adapters
A-150	-	Large Bore Short Hex Cap
A-151	-	Used Only with Hydro Inflating Valves.
A-152	VC-10	Large Bore Short Dome Cap
A-155	-	Plastic Large Bore Sealing Cap

VALVE ADAPTERS

AD-1
Adapts Large Bore valve down to Standard Bore. Fits in 305-32 valve core threads.

8807N-4
Adapts Large Bore valve down to Standard Bore. Fits over .485-26 valve cap threads.

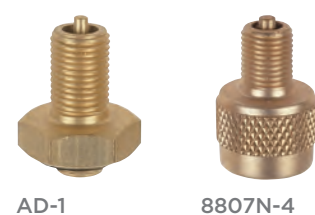
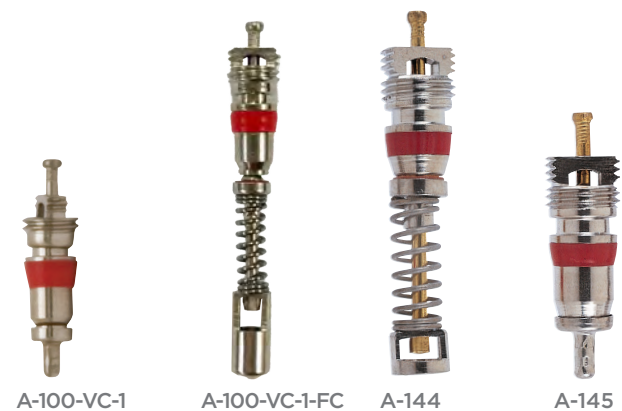

GROMMETS

HALTEC NO.	TIRE & RIM NO.	FITS	TEMP. RATING	USED ON
5976-5	RG-54	.453 Valve Hole	-60 - 250° F	TV-416, 416L, 6008
5976-6	RG-39	.625 Valve Hole	-60 - 250° F	TV-416, 416L
G-160	RG-22	.812 Valve Hole	-60 - 250° F	H-41, T-81, T-30, DS-385, DS210
G-162	RG-16	.812 Valve Hole	-60 - 250° F	Turret Valves, PB-210, H-1000
G-165	-	.812 Valve Hole	-60 - 250° F	K-431, K-665
G-166	RG-7	.625 Valve Hole	-60 - 250° F	TV-618, 621A, 622A, 623A
G-170	RG-15	.625 Valve Hole	-60 - 250° F	TV-500 Series, TV-570 Series
G-170S	RG-15	.625 Valve Hole	-75 - 400° F	Heat-Resistant Grommet for TV-570 Series
G-172	RG-46	.625 Valve Hole	-60 - 250° F	TV-509, 510, 511
G-174	RG-48	.625 Valve Hole	-60 - 250° F	TV-513, 515
G-550	RG-70	9.7mm Valve Hole	-20 - 400° F	Fits TV-550 Series
G-551	RG-70	9.7mm Valve Hole	-40 - 250° F	Fits TV-550 Series



HEX NUTS

HALTEC NO.	TIRE & RIM NO.	FITS	USED ON
451	HN-15	11/16-16	H-41, T-30
452	-	.485-26	K-431
463	-	-	753S, 810F (Jam Nut)
464	HN-1	.485-26	L.B. Valves, 753S, 810F, 867,TV-618A, 621A, 622A, 623A
10071	HN-13	.406-26	TV-500 Series, TV-570
B-222	HN-80	11/16-24	M-1900, M-1950, H-4000, MR-800, MR-850, T-81
B9-2	LN-13	11/16-24	B9A Assembly
HN-17	HN-17	.406-28	TV-509, 510, 511
HN-18	HN-18	.406-28	TV-513, 515
HN-21	HN-21	-	TV-540 Series
HN-22	HN-22	.375-32	H-543C, TV-540, TV-550 Series
LN-1	HN-2	-	FE-300 Series
HN-23	HN-23	.375-32	70MS-7



O-RINGS

HALTEC NO.	TIRE & RIM NO.	TEMP. RATING	USED ON
O-320	-	-40 - 250° F	Swivel Valves, H-43, H-42
O-330L	RG-60	-75 - 400° F	TR-540 Series Valves
10008	-	-40 - 250° F	T-670
10009	-	-40 - 250° F	M-5000
A-126	-	-40 - 250° F	R-762S, R-525 & SLB Angle Connections
A-127	-	-40 - 250° F	R-520, R-372, R-521
A-128	-	-40 - 250° F	DS-215, DS-226



WASHERS

HALTEC NO.	TIRE & RIM NO.	FITS	USED ON
453	-	11/16-24	K-431, K-665
10058	RW-8	.406-28	TV-500 Series, TV-570 Series
10058B	RW-8	.406-28	TV-500 Series, TV-570 Series
RW-13	RW-13	.410-28	TV-416
W-1101-1	RW-11	.485-26	TV-618A, TV-621A, 622A, 623A

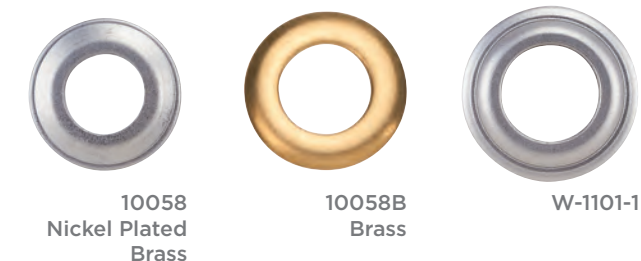



TANK VALVES

Utilized on pressure containers where gauging or servicing may be required. Tank valves are used with various gases, fluids, and operating pressures. For specific application, please contact Haltec for technical assistance.

HALTEC NO.	OAL	BASE THREAD	CAP THREAD	HEX SIZE
TV-399	1 5/16"	1/8" NPT	.305-32	7/16"
TV-400	1 5/16"	1/4" NPT	.305-32	9/16"
TV-401	27/32"	1/8" NPT	.305-32	7/16"
TV-402	1 5/16"	1/8" NPT	.305-32	7/16"
H-47	1 19/32"	1/4" NPT	.482-26	9/16"
TV-400S	1"	1/4" NPT	.305-32	9/16"

RADIAL TIRE BEAD SEATERS

One-piece rubber tube for mounting hard-to-seat radial, bias belted, or conventional truck tires. As the tire is inflated, the lubricated bead seater forms a seal between the rim and tire allowing the air pressure to force the beads into the rim flange. As proper pressure is reached, the bead seater slides out and over the rim.

FOR TRUCK TIRES:

- TC-30 for 13" Rims
- TC-40 for 14-15" Rims
- TC-50 for 16.5" and 17.5" Rims
- TC-60 for 19.5" Rims
- TC-63 for 20" Rims
- TC-70 for 22.5" and 24.5" Rims

FOR PASSENGER TIRES:

- PC-1 for 13" Rims
- PC-2 for 14" and 15" Rims
- PC-3 for 15" Rims
- PC-4 for 17" Rims
- PC-5 for 18" Rims
- PC-6 for 20" Rims
- PC-7 for 12" Rims

Note: OSHA regulations require that service personnel use a clip-on air chuck with an inline inflator at a recommended distance that keeps the employee out of the trajectory of the tire and rim. After beads are seated, put tire and rim into approved inflation cage and continue to inflate to prescribed air pressure.

RIM GUARD HX-44

Protection cover for aluminum and chrome bolt hole areas while using an impact wrench.

WHEEL SHIELD HX-24

Protection cover for aluminum and chrome wheels. Snaps into place. Shows proper torque sequence numbers for wheel nuts.



DUAL FOOT TRUCK SERVICE GAUGE

Haltec offers a wide variety of service gauges to accommodate the numerous tire and wheel configurations encountered by the service personnel. Choose the gauge that best fits your particular needs.

HALTEC NO.	OPERATING RANGE	INCREMENTS	BAR	CHUCK STYLE	FINISH
DT-150	0-150 PSI	.5 PSI	N/A	Angled Chuck	Chrome
GA-135	10-150 PSI	2 PSI	Nylon	Angled Chuck	Chrome
GA-135S	10-150 PSI	2 PSI	Metal	Angled Chuck	Chrome
GA-140	10-160 PSI	2 PSI	Nylon	Angled Chuck	Chrome/Poly
GA-155	10-150 PSI	2 PSI	Nylon	Straight-on 30° Reverse	Chrome
GA-155S	10-150 PSI	2 PSI	Metal	Straight-on 30° Reverse	Chrome
GA-155S-RCL**	10-150 PSI	2 PSI	Metal	Straight-on 30° Reverse	Chrome
GA-165*	10-150 PSI	2 PSI	Nylon	Straight-on 30° Reverse	Black Polyurethane
GA-165S-RCL**	10-150 PSI	2 PSI	Nylon	Straight-on 30° Reverse	Chrome
GA-175*	10-150 PSI	2 PSI	Nylon	Angled Chuck	Black Polyurethane
GA-185	10-150 PSI	2 PSI	Nylon	Straight-on 180° Reverse	Chrome
GA-185S	10-150 PSI	2 PSI	Metal	Straight-on 180° Reverse	Chrome
GA-189S-RCL**	10-150 PSI	2 PSI	Metal	Straight-on 30° Reverse	Aluminum

**Recalibratable, *Extended Head
Note: DT-150 uses CR-2032 battery

DUAL FOOT TRUCK HIGH-PRESSURE GAUGE

HALTEC NO.	OPERATING RANGE	INCREMENTS	BAR	CHUCK STYLE	FINISH
GA-130	20-120 PSI	2 PSI	Nylon	Angled Chuck	Chrome
GA-150	20-120 PSI	2 PSI	Nylon	Straight-on 30° Reverse	Chrome
GA-160*	20-120 PSI	2 PSI	Nylon	Straight-on 30° Reverse	Black Polyurethane
GA-170*	20-120 PSI	2 PSI	Nylon	Angled Chuck	Black Polyurethane

*Extended Head

TGG-1 TIRE GAUGE GRIP

Allows a positive grip on your gauge during inclement weather conditions and serves as a protective cushion should the gauge be inadvertently dropped. Can be used on all dual foot truck service gauges.

GA-155S-RCL-HD CHROME DUAL FOOT METAL BAR SERVICE GAUGE

Chrome body. Easy to read metal slide bar. Calibrated 10-150 PSI. Straight on 30° reverse head for hard-to-reach valves. Built to withstand harsh working conditions.

